

DH-SD40/42/42C112I-HC

1.3Mp Mini HDCVI PTZ Dome Camera



SD40112I-HC

SD42112I-HC

SD42C112I-HC



Features

- Powerful 12x optical zoom
- 25/30/50/60fps@720P
- DWDR, Day/Night (ICR), DNR (2D&3D), Auto iris, Auto focus, AWB, AGC, BLC
- Max 300°/s pan speed, 360° continuous pan rotation
- Control over coaxial cable, long distance real-time transmission
- Up to 255 presets, 5 auto scan, 8 tour, 5 pattern
- Built-in 2/1 alarm in/out
- Support intelligent 3D positioning with DH-SD protocol
- IP66, OSD

Dimensions (mm)

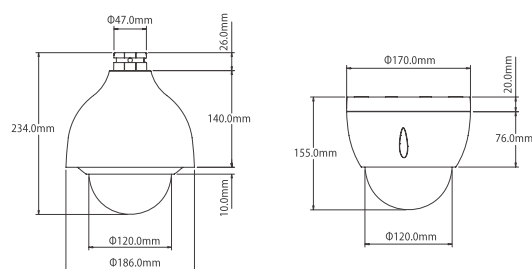

Technical Specifications

Model	DH-SD40112I-HC	DH-SD42112I-HC	DH-SD42C112I-HC
Camera			
Image Sensor	1/3" Exmor CMOS		
Effective Pixels	1280(H)×960(V), 1.3Megapixels		
Horizontal Resolution	≥700TVL		
Scanning System	Progressive		
Electronic Shutter Speed	1/3s ~ 1/30,000s		
Min. Illumination	Color: 0.05 Lux / F1.6, B/W: 0.005Lux / F1.6		
S/N Ratio	More than 55dB		
Resolution	720P (25/30/50/60fps)		
Video Output	1-channel BNC HDCVI high definition video output		
Camera Features			
Day/Night	Auto(ICR) / Color / B/W		
Backlight Compensation	BLC / HLC / DWDR (Digital WDR)		
White Balance	Auto, ATW, Indoor, Outdoor, Manual		
Gain Control	Auto / Manual		
Noise Reduction	2D / 3D		
Privacy Masking	Up to 24 areas		
Digital Zoom	16x		
Lens			
Focal Length	5.1 mm~61.2mm (12x Optical zoom)		
Max Aperture	F1.2~ F2.1		
Focus Control	Auto / Manual		
Angle of View	51.3°~4.64°		
Close Focus Distance	100mm~1000mm		
PTZ			
Pan/Tilt Range	Pan: 0°~360° endless; Tilt: -2°~ 90°, auto flip 180°		
Manual Control Speed	Pan: 0.1°~200°/s; Tilt: 0.1°~120°/s		
Preset Speed	Pan: 300°/s; Tilt: 200°/s		
Preset	80(DH-SD) , 255(Pelco-P/D)		
PTZ Mode	5 Pattern, 8 Tour, 5 Auto Scan, Auto Pan		
Speed Setup	Human-oriented focal length / speed adaptation		
Power up Action	Auto restore to previous PTZ and lens status after power failure		
Idle Motion	Activate Preset / Pan / Scan / Tour / Pattern if there is no command in the specified period		
Time Task	Auto activation of Preset / Pan / Scan / Tour / Pattern by preset-time		
Protocol	DH-SD, Pelco-P/D (Auto recognition)		
Audio			
Interface	1 channel In		
Auxiliary Interface			
RS485	1		
Alarm	2/1 channel In/Out		
General			
Power Supply	AC24V / 1.5A (±10%)		
Power Consumption	12W, 22W (Heater on)	12W	
Working Environment	-40°C ~ 60°C / Less than 90% RH	-10°C ~ 60°C / Less than 90% RH	
Ingress Protection	IP66		N/A
Dimensions	Φ186mm×234mm	Φ170mm×155mm	Φ198mm×158mm
Weight	2.3Kg	1.8Kg	2.3Kg

Accessories-SD40212I-HC



DH-PFB300S DH-PFA110 Power Supply

Accessories(Optional)-SD40212I-HC



DH-PFB300C DH-PFB301C DH-PFA112 DH-PFA113 DH-PFB301S DH-PFA120 DH-PFA150 DH-PFA151

Accessories(Optional)-SD42212I-HC



DH-PFA102 DH-PFB300S DH-PFB300C DH-PFB301C DH-PFA112 DH-PFA113 DH-PFA120 DH-PFA150 DH-PFA151